



SX Performance™ Model 15412 Fuel Pressure Regulator
Carbureted Pressure Regulator
Performance Specifications and Installation Instructions

Relief Pressure Adjustment Range:	5-10 psi
Inlet Port Size:	3/8" NPT
Outlet Port Size:	2 x 3/8" NPT
Note: This Regulator is not legal for sale or use on emission controlled motor vehicles.	

CAUTION!

Installation of this product should only be performed by those persons knowledgeable in the repair and modification of high performance automotive fuel systems.

WARNING: Fuel system may be under pressure!

Do not loosen fuel system connections until pressure has been relieved. Fuel may leak when loosening fuel system connections. Eliminate potential fire hazards before loosening any fuel system connections. Always wear appropriate personal safety equipment such as safety goggles and other apparel as needed, for protection from debris and sprayed gasoline. Work in a well-ventilated area and keep an approved fire extinguisher nearby. Extinguish any open flames and eliminate all sources of ignition in the area of the vehicle before proceeding with the installation.

Typical Installation Instructions:

1. Assemble the fuel pressure regulator as shown in Figure 1. Leave the adjuster screw jam nut loose at this time.
2. With the ignition off and engine cool, disconnect the negative battery terminal and relieve the fuel system pressure. **See the above warning for proper precautions.**
3. Disconnect the existing regulator fuel lines, if equipped. Plug the open fuel lines to prevent foreign matter from entering the fuel system. Remove the existing regulator mounting screws and remove the existing regulator.
4. Determine the new regulator mounting location. Replace existing fuel lines as necessary so they line up with the new regulator. If necessary, mark and drill mounting bracket holes using the bracket as a template. The bracket may be modified through bending or cutting, to ease installation. Use clear enamel to cover any cut, ground or damaged coating as a result of altering bracket.
5. Install the fittings as shown in Figure 2. Use thread sealer (not supplied) on the fitting threads. An 3/8 NPT plug can be used to plug any unused outlet port.
6. Install the regulator and bracket assembly at the desired location.
7. Connect and tighten fittings to the inlet and outlet fuel lines.
8. Install the 1/8-27 NPT plug (supplied) or connect a fuel pressure gage to the gage port using a 1/8 NPT male thread and thread sealer (not supplied).
9. Reconnect the negative battery terminal. Start the pump (or engine if required) and check the fuel system for leaks and pressure.

WARNING!

If any leaks exist, immediately shut off the pump or engine and repair before continuing.

10. Once steady pressure is obtained and no leaks are evident, loosen the jam nut on the top of the regulator, and turn the adjusting screw until the desired fuel pressure is obtained. Tighten the jam nut and recheck the fuel pressure. The engine should be running while setting final fuel pressure.

Congratulations, your vehicle can now take full advantage of the exceptional performance capabilities of your new SX Performance™ product!

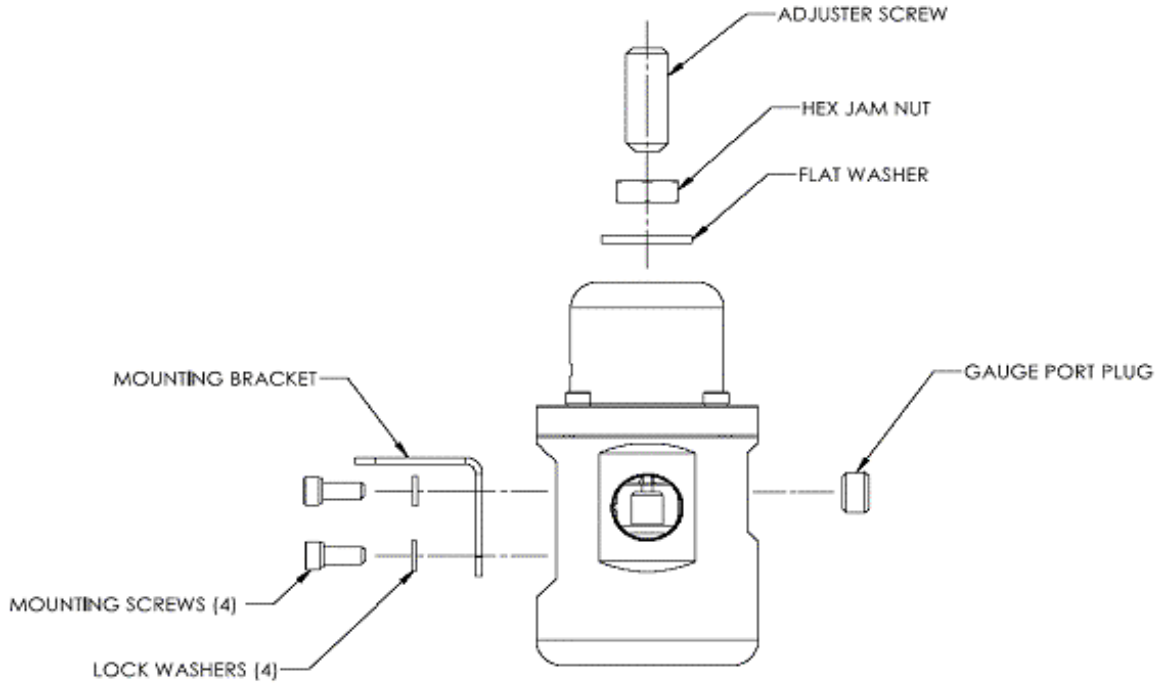

Figure 1 – SX Performance™ Model 15412 Fuel Pressure Regulator Assy.

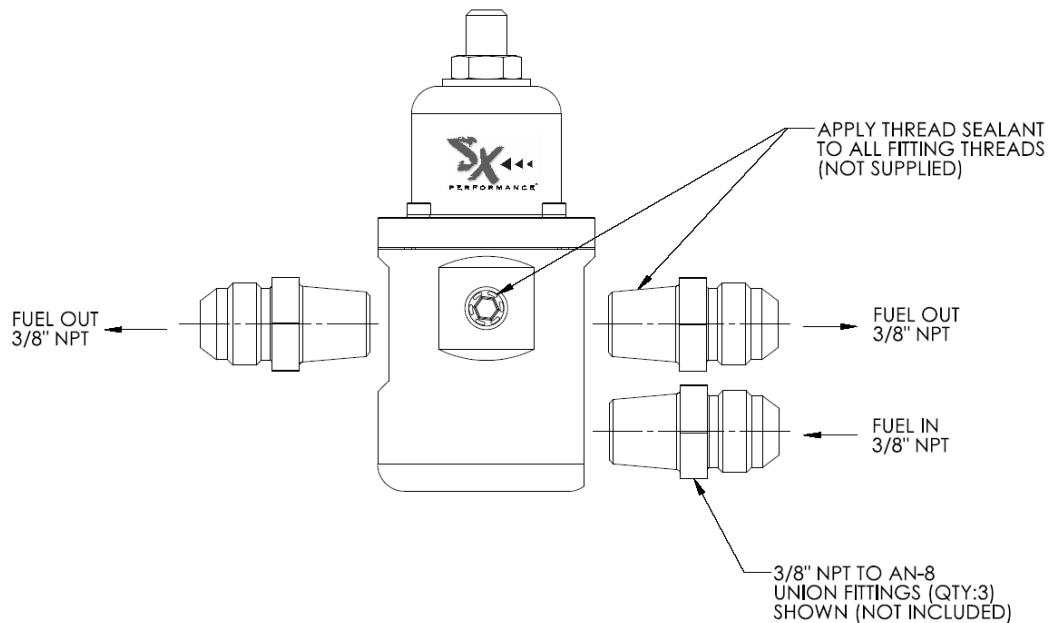

Figure 2 – SX Performance™ Model 15412 Fuel Pressure Regulator Installation

This document was created with Win2PDF available at <http://www.daneprairie.com>.
The unregistered version of Win2PDF is for evaluation or non-commercial use only.